



CHILD CAR SEAT FOR GROUPS 1+2+3 INSTRUCTION MANUAL

GB

IT

ES

FR

PT

DE

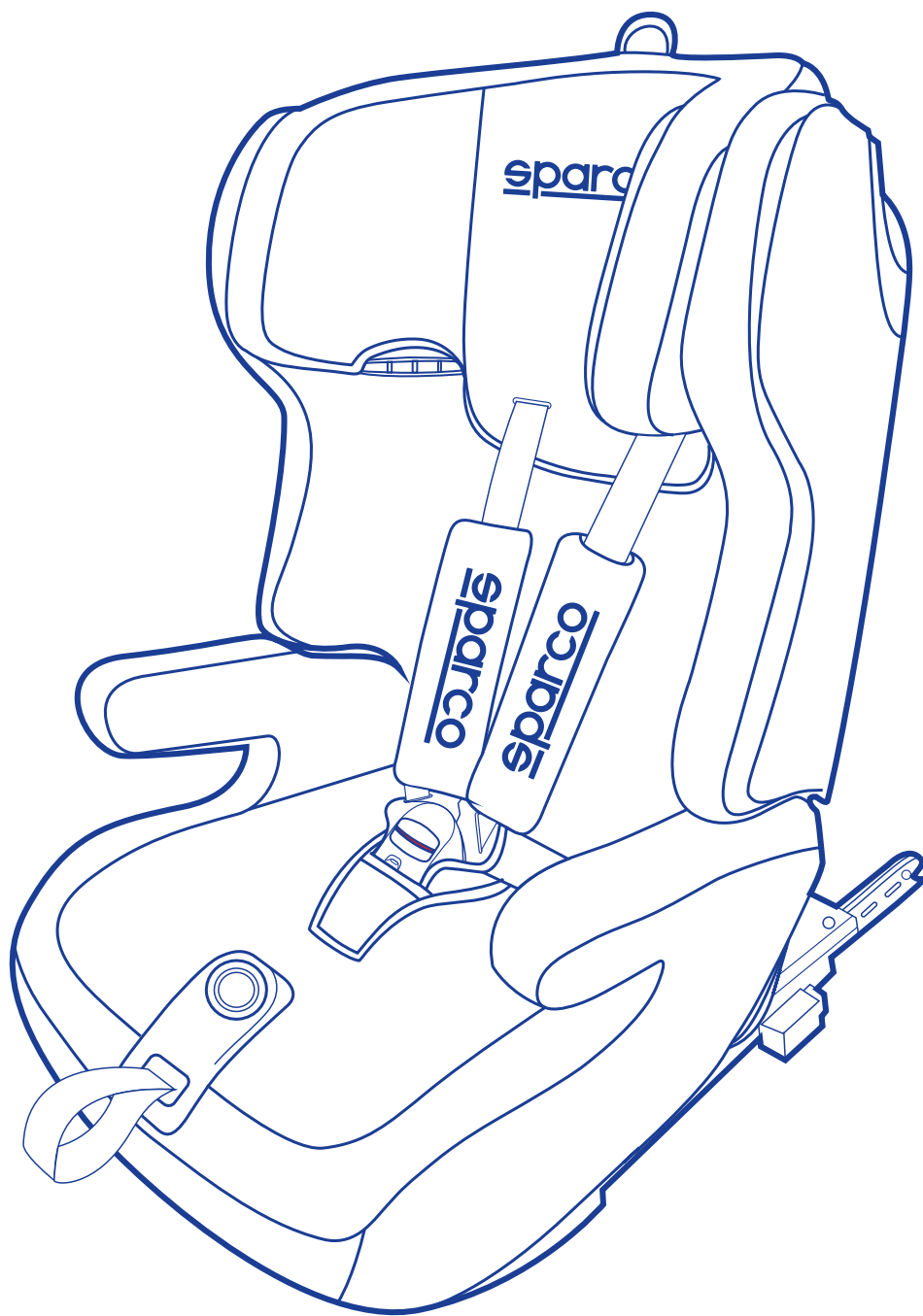

ECE R44/04
Groups **1+2+3**



Dear parents

- Thank you very much for purchasing our product.
- The credible design in accordance with somatology and excellent functionality affords the safest and most comfortable journey when your child is in this seat.
- In order to maximize the safety and functionality of this child seat, please adjust the child restraint till it is suitable for your child's stature before using our product and then install it carefully.
- Research shows that a high number of car safety seats are incorrectly installed. Therefore we would ask you to please take the time to read through this instruction manual carefully. Our product offers maximum safety only when it is used in accordance with the instructions.
- Continuous research by our development team, user tests and consumer reviews ensure that we are kept fully up to date in the field of child safety in cars. Therefore, if you have any questions concerning the use of the our product, please do not hesitate to contact us.
- You can see our contact information in the service card.
- This child seats has been designed for the European market and conforms to the car seat regulations currently in force: European Union ECE R44; PLEASE NOTE that this seat doesn't meet the USA regulation.

Important

Warning

- Read this instruction manual carefully.
- The correct fitting of the ISOFIX and Top Tether anchoring systems or 3-point belt is of vital importance for the safety of your child.
- For any future use of the seat, it is important that you keep the instruction manual carefully. There is a pocket on the side of the base where the instruction manual can be stored with the child restraint for future reference and use.
- Never leave your child unattended in the car.
- Do not use a child safety seat if the vehicle seat is equipped with a front airbags - this can be dangerous. This does not apply to so-called side airbags.

- Before using our product, please read the instruction manual carefully. This product is a safety product and is only safe when used in accordance with the instruction manual.

- The product must only be used on a forward facing seat that is fitted with the ISOFIX and Top Tether anchoring systems or 3-point belt which is approved according to ECE R16 or an equivalent standard. The product may be used on either the front or the back seat. However, we recommend that it is fitted on the back seat.

- The product has been approved according to the strictest European safety standards (ECE R44/04) and is suitable for Group I (9-18kg) with the ISOFIX and Top Tether anchoring systems, Group II (15-25kg) and Group III (22-36kg) with 3-point belt or ISOFIX attachment with 3-point belt.

- After an accident the seat may become unsafe due to damage that may not be immediately noticeable. It should therefore be replaced. The safety of the seat can only be guaranteed by the manufacturer if it issued by the original owner.
- We strongly advise not to use a second-hand product, because it is not possible to know exactly what has previously happened to it or if it holds any damages that would affect the safety performance.
- The harness pads are important for the safety of your child, therefore use them at all times.
- Ensure that all luggage and objects likely to cause injury in the event of an accident are properly secured or stored away.
- It is recommended that the car seat should not be used more than 5 years from the date of manufacture. The properties of the product may deteriorate due to, for example, ageing of the plastic and this may not be visible.
- The moving parts of the car seat should not be lubricated in any way.
- The child car seat must not be used without the cover. Please use an original cover, as the cover contributes to the safety of the seat.
- The seat must be secured with a seat belt or ISOFIX and Top tether, even when it not on use. An unsecured seat may injure other passengers in the car in event of a sudden stop.
- The rigid items and plastic parts of a child restraint should be correctly installed or clipped away during everyday use of the vehicle to avoid becoming trapped by a movable seat or in a door of the vehicle.
- Ensure that the seat is not damaged by heavy luggage, adjustable seats or slamming the car door etc.

- No alterations may be made to the product as this could affect part of, or the overall safety of the seat.
- In hot weather the plastic and metal parts of the product may become hot. You should attempt to cover the seat when the car is parked under direct sunlight or in hot weather.
- In order to prevent damage to the cover, do not remove the product's logo.
- Remember to use the seat even in the shortest of journeys, as this is when most accidents tend to occur.
- Before purchase, please check that the seat fits properly in your car.
- Take a short break during long journeys so that your child has some time for relaxation.
- Set a good example yourself and always wear your seat belt.
- Inform your child that he/she should never play with the harness buckle.

Questions

Contact your supplier or importer if you wish to make a warranty claim or have any other questions.

Your car seat can be fixed safely on almost seats of the cars. However, on some seats the belts are fixed so that proper installation is not possible, in that case, try another seat.

Know your car child seat

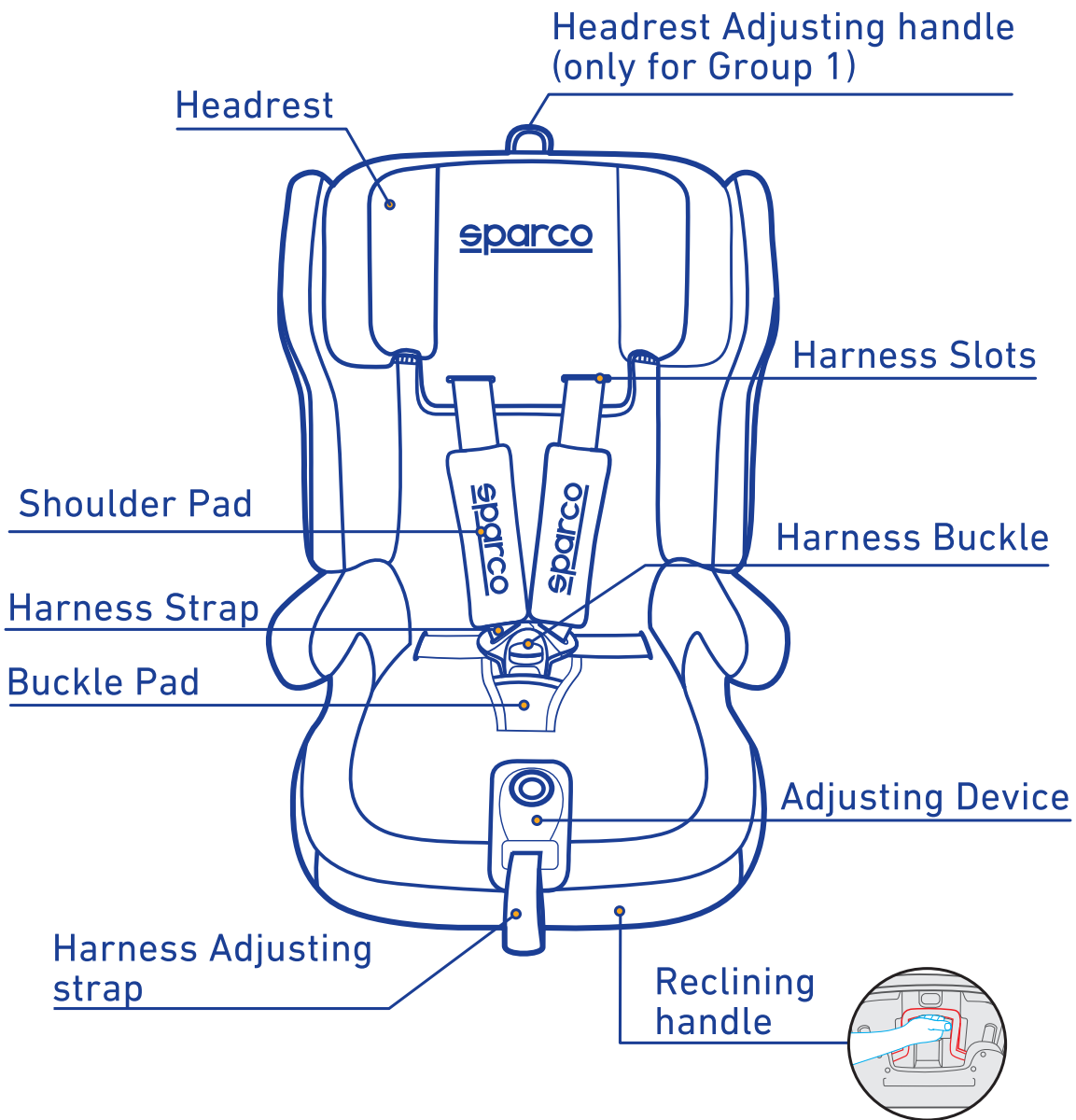

Know your car child seat

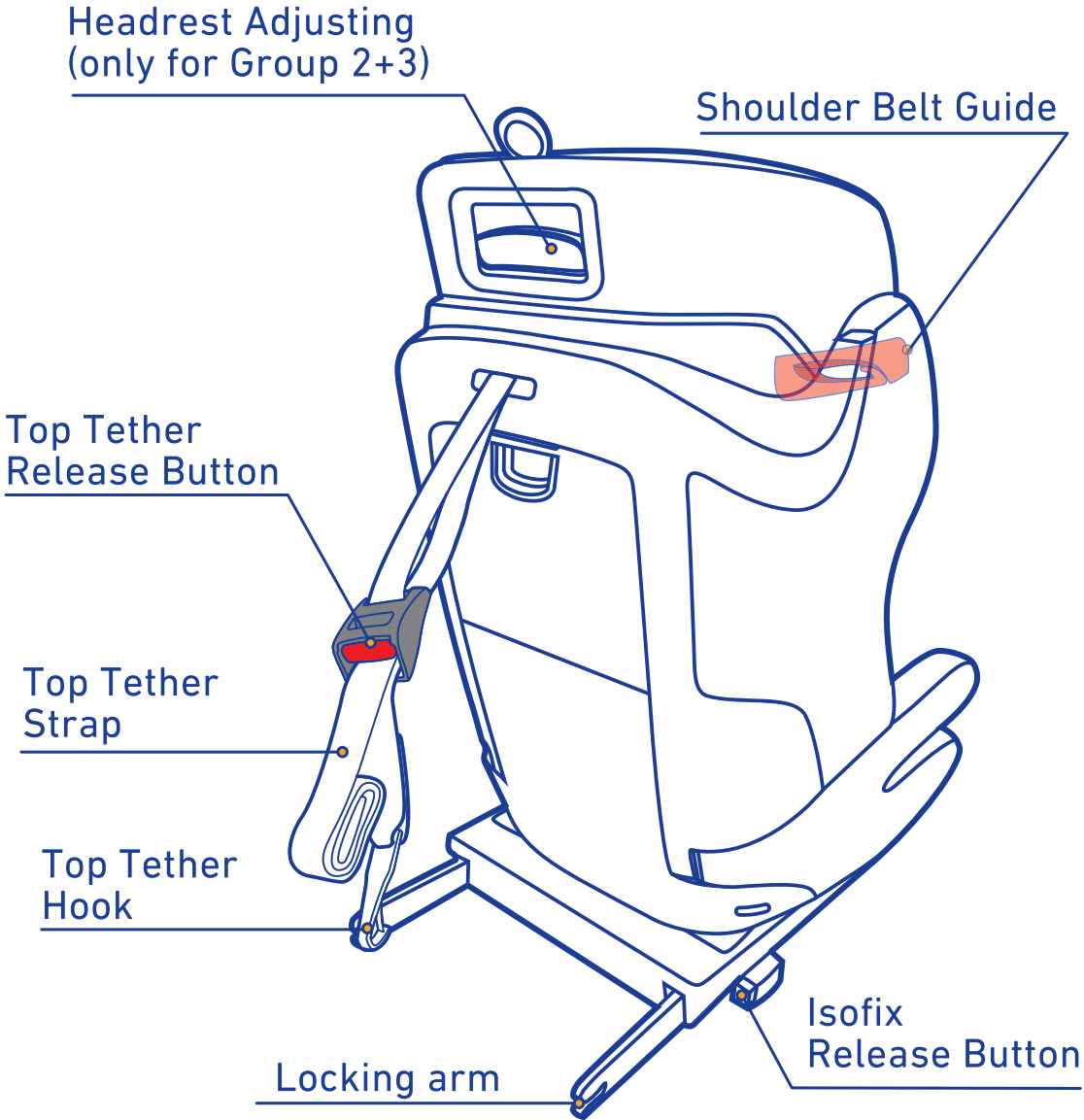

Suitability

1. Certification



...as a child safety seat installed in a vehicle.

sparco Child Safety Seat	Tested and certified according to ECE* R 44/04	
	Group	Body Weight
SK700	1+2+3	9-36kg

The child safety seat has been designed, tested and certified according to the requirements of the European Standard for Child Safety Equipment (ECE R 44/04).

The seal of approval E (in a circle) and the approval number are located on the approval label (sticker on the child safety seat).

This approval will be invalidated if you make any modifications to the child safety seat. Only the manufacturer is permitted to make modifications to the child safety seat.

Use in the vehicle

GB

IT

ES

FR

PT

DE

2. Use in the vehicle

Warning



DO NOT use with 2-point belt.
Please install with the 3-point belt.

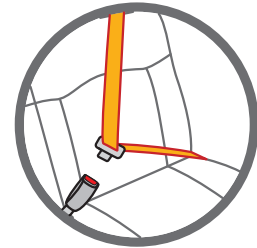





Please observe the regulations applicable to your particular country.
The safety belt must be approved to ECE R 16 or a comparable standard.
Do not use with a 2-point belt.
The seat can only be used if the vehicle seat is equipped with a 3-point belt.

You can use your child car seat as follows:



Use in the vehicle

• In the direction of travel	Yes
• Against the direction of travel	No
• With 2-point belt	 No
The use of a 2-point belt substantially increases the risk of injury to your child in the event of an accident.	
• With 3-point belt	 Yes
The safety belt must be approved to ECE R 16 or a comparable standard (see test label on belt with an "E" or "e" in a circle).	
• With the ISOFIX and Top Tether anchoring systems	Yes
If there is a front airbag: Slide the passenger seat a long way back and refer to any instructions in vehicle owner's manual.	
• On front passenger seat	 Yes
Do not use on passenger seats with a front airbag! The front passenger seat may be used with or without ISOFIX, with the same notes as currently given for the ISOFIX (slide the seat back and refer to vehicle instructions).	
• On outer rear seat	Yes
• On centre rear seat	 Yes
Can be used if the vehicle seat is equipped with a 3-point belt	

(Please observe the regulations applicable to your particular country).

Securing your baby

GB

IT

ES

FR

PT

DE



For the protection of your baby.

- Always secure your child in the car seat using the harness.
- Never leave your child unattended in the car seat when placing it on elevated surfaces (e.g. a table, nappy changing unit, etc.).
- Never allow the strap end to become caught in moving parts (e.g. automatic doors, escalators, etc.).
- Caution! The plastic parts of the car seat heat up in the sun - overexposure to the sun may cause your child to be burnt from making contact with these heated plastic parts. Protect your child and the car seat against intensive solar radiation (e.g. by putting a light cloth over the seat during hot or warm weather).
- Take your child out of the car seat as often as possible during journeys to relieve its spine. We recommend frequent breaks during long journeys. Even outside of the car, please avoid leaving your child in the car seat for too long.

Securing your baby

3.1 How to adjust the belts, headrest and seat positions

Important

The correct belt height of the shoulder belts are attained when the belt disappears into the shell slightly above the shoulder of the child.

Make sure that the shoulder belts fit properly over the shoulders of the child.

3.1-1 Adjusting the belts

- Loosen the harness straps by pressing the release button and pulling the harness straps as far as you can.

Note! Do not pull the shoulder pads.

3.1-2 Twelve heights of the headrest

- The headrest can be set at five different heights in group 1 mode with the shoulder belts axle in place. There are seven additional positions in Group 2 & 3 mode once the shoulder belts axle and harness straps have been removed.
- Press the button on the headrest handle on the top of the seat. It is important to make sure the headrest fits properly to the child's head.

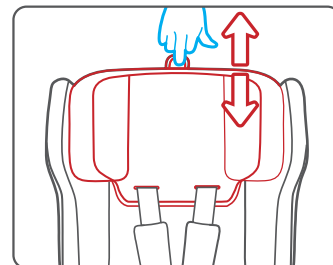

3.1-3 Stepless adjustment device

The recline angles of the car seat can be adjusted by reclining handle. (Only For Group 1).

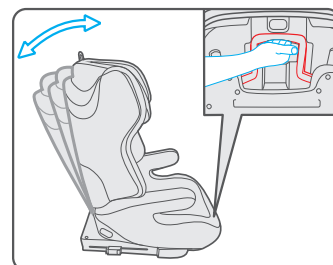

Securing your baby

3.2 Securing your baby using the harness

- Loosen the harness straps by pressing the release button and pulling the harness straps as far as you can.

Note! Do not pull the shoulder pads.

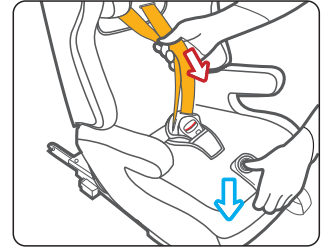

- Open the harness buckle, then place the harness straps to the sides of the car seat. Put the child into the car seat.

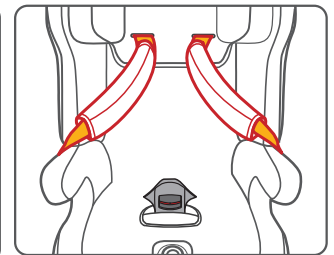
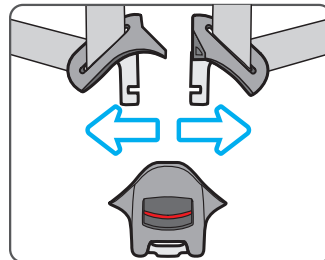

- The correct belt height of the shoulder pads is attained when the strap disappears into the shell slightly above the shoulders of the child. Make sure that the harness straps fit properly over the shoulders of the child.



- Slide the buckle tongues together and insert them into the buckle - correct connection will create an audible "click" sound.

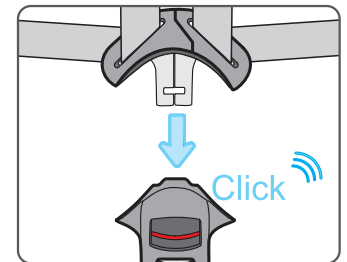

- Tighten the straps by the harness adjustment strap and make sure the tightness is comfortable for your child.

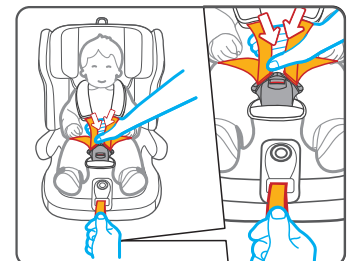

Caution Do not twist or interchange the harness straps.

Securing your baby

3.3 Tightening the harness

Caution

Pull the ends of the straps straight towards you, not upwards or downwards.

Please pay attention to the strap end whilst traveling - it should always be attached to the cover (especially outside the car).

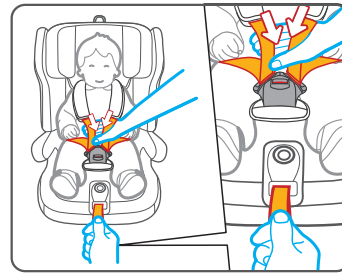

3.4 Checklist to ensure that your child is buckled up correctly

IMPORTANT

 For the safety of your child, please check that...

- The harness straps of the car seat are a comfortable but firm fit around your child.
- The harness straps are adjusted correctly.
- The harness straps are not twisted.
- The buckle tongues are engaged in the harness buckle.

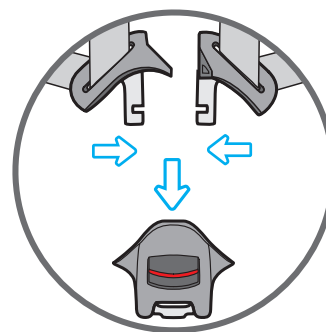

4. Installation in the vehicle



Please do not leave your child unattended in the vehicle, even in the child safety seat .



For the protection of all vehicle occupants.

In the case of an emergency stop or an accident, unsecured persons or objects may cause injury to other vehicle occupants. Please always check that...

- The backrests of the vehicle seats are locked in (i.e.that a foldable rear seat bench latch is engaged).
- All heavy or sharp-edged objects in the vehicle (e.g. on the parcel shelf) are secured.
- All persons in the vehicle have their seat belts fastened correctly.
- The child safety seat is always secured when it is in the vehicle, even if no child is being transported.

To protect your vehicle

Some vehicle seat covers made of sensitive materials (e.g. velour, leather, etc.) may develop wear marks when child seats are used.

This can be avoided by placing a blanket or towel under the child seat.

ISOFIX and Top tether

4.1 Installation of Group 1 for children whose weight is between 9-18kg with ISOFIX and Top tether.

IMPORTANT

First check if there are 2 ISOFIX anchorages in the perpendicular intersection of the vehicle seat back and seat cushion, as well as the user-ready tether anchorage behind the vehicle seat.

Tips: The user-ready tether anchorage in cars is usually permanently installed on the inner rear luggage shelf or on the vehicle floor. For further details you should read your vehicle guidelines or contact the vehicle manufacturer.

- Press the ISOFIX release button and push the ISOFIX connectors forward as far as possible.

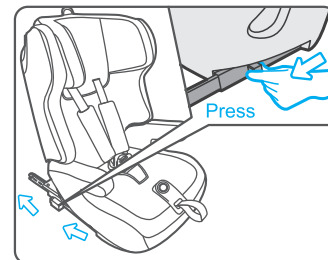

- Push the ISOFIX connectors directly into the anchorages until you hear an audible "click" sound.

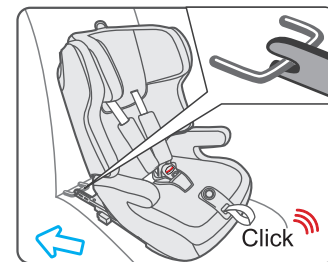
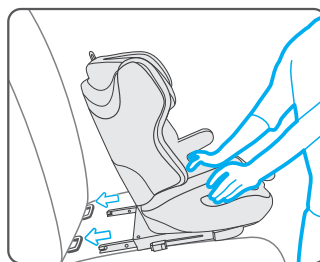

- Grasp the seat body to check the seat if it is fastened tightly or if it shakes. If the seat shakes and the ISOFIX connectors are pulled out, please repeat the above steps and reinstall it again.

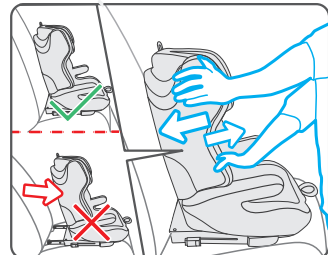

ISOFIX and Top tether

GB

IT

ES

FR

PT

DE

4.1 Installation of Group 1 for the children whose weight between 9-18kg with ISOFIX and Top tether.

- Pull out the top tether and press the tether strap release button to extend the strap until it is long enough in order to hook on to the user-ready tether anchorage behind.

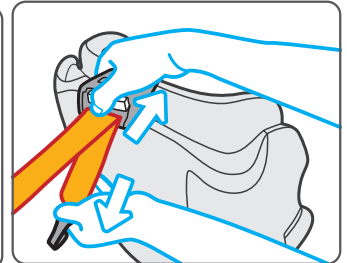
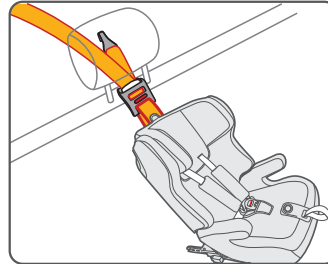

- Hook the tether strap hook onto the user-ready anchorages. There may be 3 anchorages for the hook to connect to, please find the one best suited to connect to.

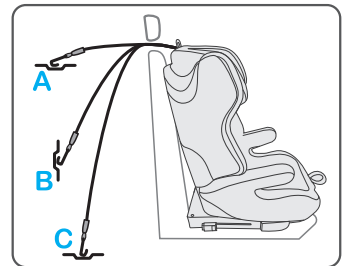
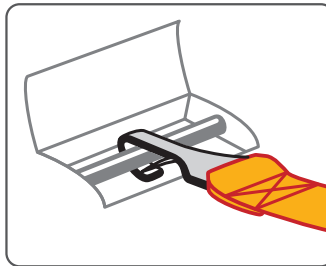

- Pull the tether strap on the other end back to tighten the top tether.

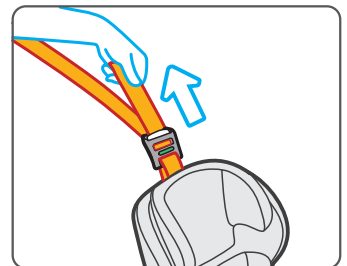

Caution

If the top tether is tightened favorably and correctly, a green mark will turn up on the other end of the strap release button, please check for it.

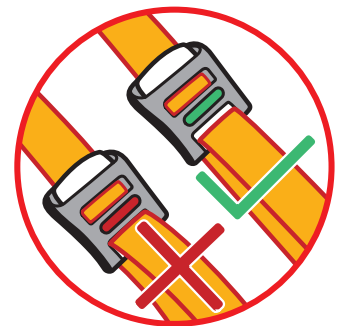

Group 2+3 Car belt installation

4.2 Installation of Group 2+3 for children whose weight between 15-36kg.

- Before the installation, please put away the harness system of the child car seat.

Note: The Child insert, Harness strap, Harness buckle, Buckle pads & Shoulder pads should be stored away safely for future use (see 5.1 Removing the 5-point harness system and cover).

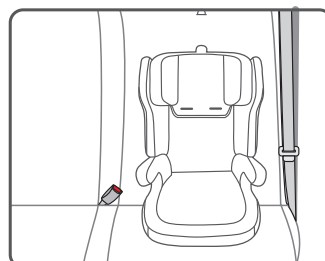

warning

Do not to use any load bearing contact points other than those described in the instructions and marked in the child restraint.
The belt must be routed as shown in the instructions.

- Adjust the height of the headrest to suit your child.
- Put the shoulder belt through the shoulder belt guide under the headrest.
- Place your child into the car seat and pass the belts through the bottom of the armrest. Fasten the car belt with an audible “click” sound.
- Make sure the Lap belt is stretched as low as possible over the child’s hips, within the Belt guides, and fastened into the buckle. The Shoulder belt must cross midway between child's shoulder and neck.

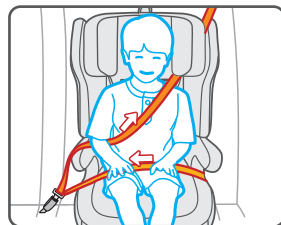
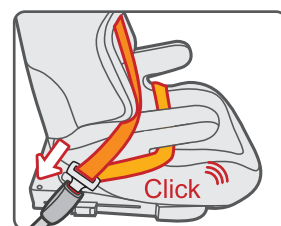
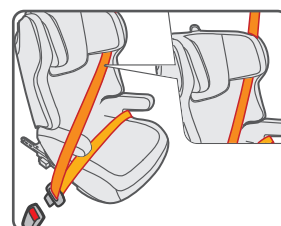
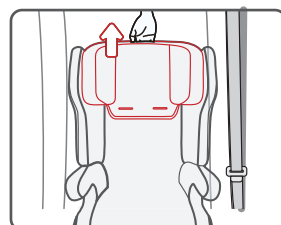

Group 2+3 ISOFIX attachment + car belt installation

4.3 Installation of Group 2+3 for children whose weight between 15-36kg.

Before the installation, please put away the Harness system of child car seat.

Note: The child insert, Harness strap, Harness buckle, Buckle pads & Shoulder pads should be stored away safely for future use (see 5.1 Removing the 5-point harness system and cover).

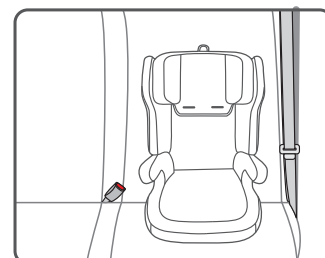

warning

Do not to use any load bearing contact points other than those described in the instructions and marked on the child restraint.
The belt must be routed as shown in the instructions.

- Adjust the height of the headrest to suit your child.
- Push the ISOFIX connectors directly into the anchorages until you hear an audible “click” sound.
- Place your child into the car seat and pass the belts through the bottom of the armrest. Fasten the car belt with an audible “click” sound.
- Make sure the Lap belt is stretched as low as possible over the child’s hips, within the Belt guides and fastened into the buckle. The Shoulder Belt must cross midway between child's shoulder and neck.

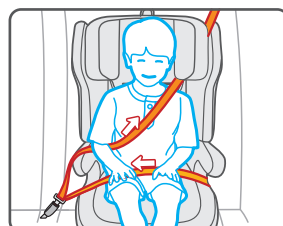
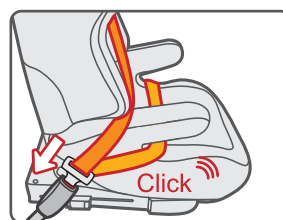
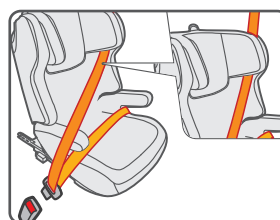
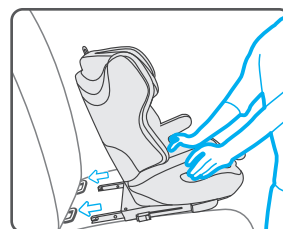
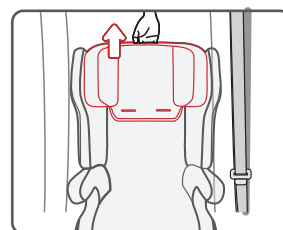

Care instructions

5.1 Hiding the 5-point harness system and cover.

- Pull the handle to open the backplane.
- Press the adjustment device and pull the harness strap out of the strap yoke to unlock it.
- Pull the shoulder strap axle out from the gap of the shell. Then untie the shoulder strap and pull it out from the harness slots.
- Roll the belt together, then hide it in the slot in bottom of the backrest.
- After the above steps, pull the cover around the adjusting device down and take it out from the edge of the adjusting device. Then remove the 5-point harness system, headrest cover and shell cover. At the same time also hide the buckle in the slot as shown in the picture.

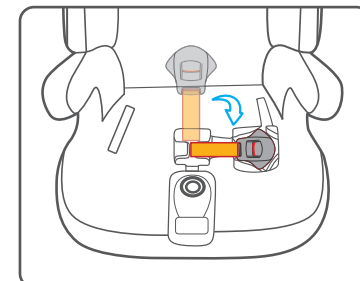
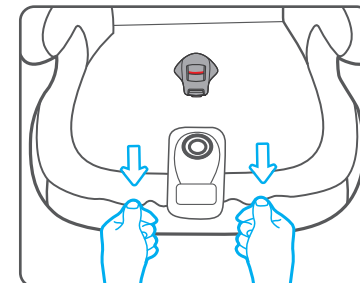
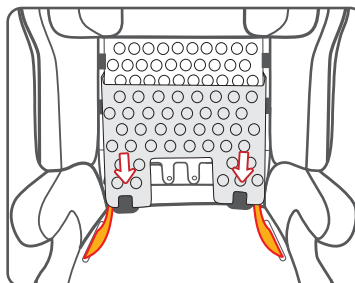
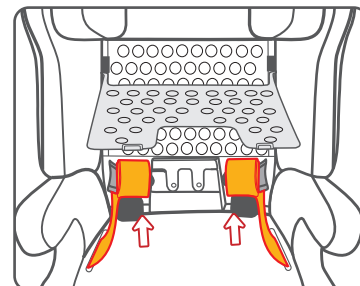
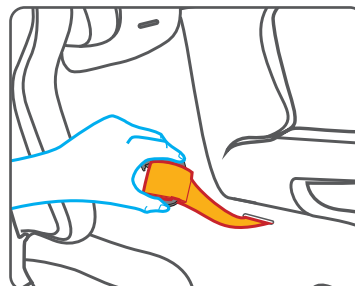
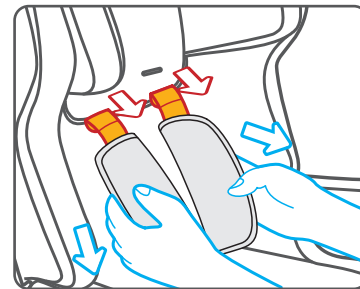
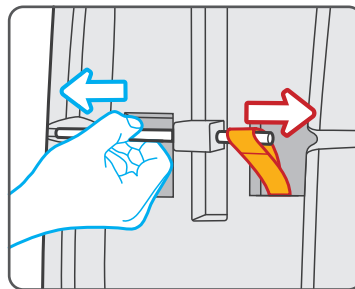
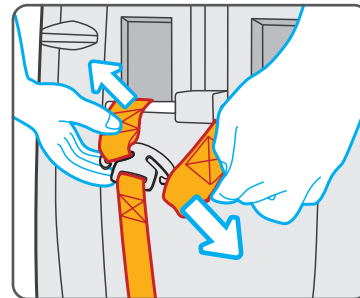
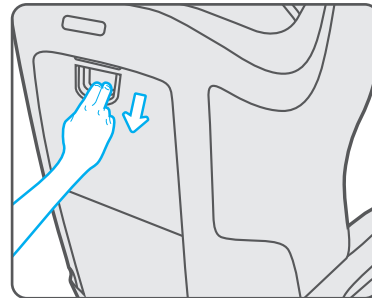

Care instructions

GB

IT

ES

FR

PT

DE

5.2 Refitting the 5-point harness system and cover.

- After washing, place the cover on the shell, pull the cover around the adjusting device down and insert the cover around the edge of adjusting device.

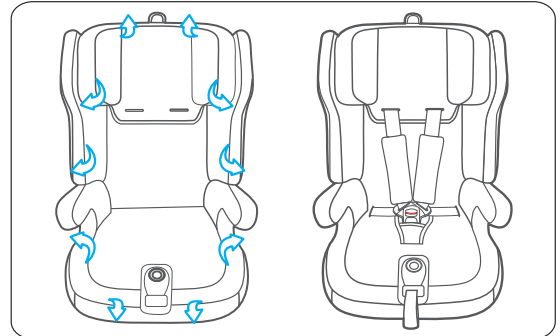

- Pass the strap clip through the strap clip slot. Then, pull both sides of the cover as shown in the picture and cover both sides of the holders.

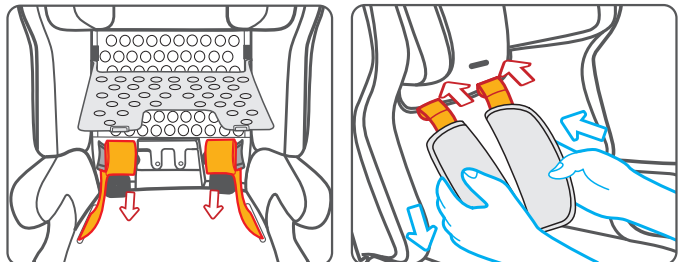

- Pass the end of the shoulder strap through the harness slot, fix into the shoulder strap axle, and lock the shoulder strap axle to the seat shell.

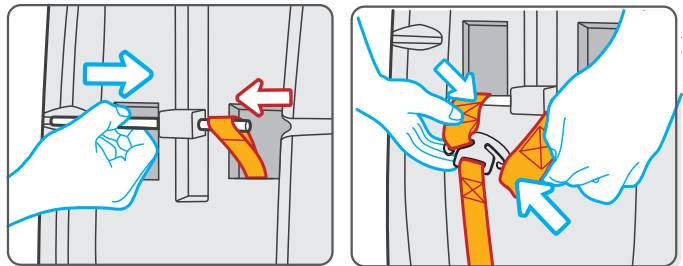

- Also put the end of the harness strap through the harness strap slot and shell, then fix it into the strap yoke. Make sure the seat straps can not be rotated.

- Close the buckle, then fasten the cover all around. Check that it works!

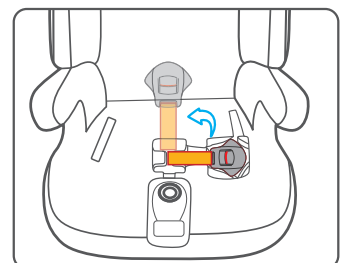

Care instructions

5.3 Cleaning.

Be sure to only use original seat covers as the seat cover is important to the proper functioning of the system. Replacement seat covers are available from your retailer or at branches.



The child seat must not be used without the seat cover.

- The cover can be removed and washed with a mild detergent using the washing machine's delicate items cycle (30°C). Please observe the instructions on the washing label of the cover. The colours of the cover may fade if washed at more than 30°C. Do not spin, and never tumble dry in an electric clothes dryer (the fabric may separate from the padding).
- The plastic parts can be cleaned using soapy water. Do not use harsh cleaning agents such as solvents. The harness can be removed and washed in lukewarm soapy water.
- Caution! Never remove the buckle tongues from the straps.

5.4 Checklist

For safety's sake read through this checklist before you set off.

- Check that the harness belt system fits properly and securely around your child and that the shoulder belts are at the correct height.
- Check regularly that the belt in the child car seat is not damaged. If it is damaged do not use your product in any circumstances and contact your supplier or importer (see address list in the service card).
- Check that you have correctly secured your child car seat with the seat belt. If you have any questions, please contact your supplier. Make sure that you have the following details to hand: Serial number underneath on the service card. Mark and type of vehicle and seat on which the child car seat used as well as the age and weight of your child.

CAUTIONS

1. This is a "Universal" child restraint. It is approved to Regulation No. 44, 04 series of amendments, for general use in vehicles and it will fit most, but not all, car seats.

2. A correct fit is likely if the vehicle manufacturer has declared in the vehicle handbook that the vehicle is capable of accepting a "Universal" child restraint for this age group.

3. This child restraint has been classified as "Universal" under more stringent conditions than those which applied to earlier designs which do not carry this notice.

4. This is an ISOFIX CHILD RESTRAINT SYSTEM. It is approved to Regulation No. 44, 04 series of amendments for general use in vehicles fitted with ISOFIX anchorages systems.

5. It will fit vehicles with positions approved as ISOFIX positions (as detailed in the vehicle handbook), depending on the category of the child seat and of the fixture.

6. The mass group and the ISOFIX size class for which this device is intended is: Group I (9-18KG), ISOFIX size class B1.

7. Only suitable if the approved vehicles are fitted with 3 point static/with retractor safety-belts, approved to UN/ECE Regulation No. 16 or other equivalent standards.

8. If in doubt, consult either the child restraint manufacturer or the retailer.



sparco

Kids

LICENSED BY **sparco**[®]

Produced and distributed under Sparco's licence by:
CAR PARTS DESIGN TRADING CO., LTD.
21st Floor Tai Yau Building 181
Johnston Road Wanchai, Hong Kong
info@carpadesign.net - www.carpadesign.net