



sparco
Kids

CHILD CAR SEAT SK800I_G23

Stature: 100-150cm

INSTRUCTION MANUAL

GB

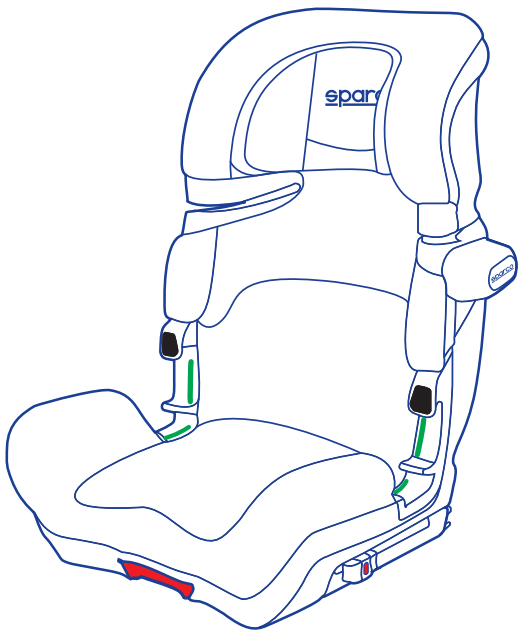

UN regulation
no.R129/03

⚠ Failure to follow the warnings on the labels and in the instruction manual can result in the death or serious injury of your child.

Notice !

SK800I_G23 | Stature: 100-150cm
i-Size R129



NOTICE

This is a i-Size booster seat Enhanced Child Restraint System. It is approved according to UN Regulation No. 129, for use primarily in " i-Size seating positions" as indicated by vehicle manufacturers in the vehicle user's manual.

If in doubt, consult either the Enhanced Child Restraint System manufacturer or the retailer.

"IMPORTANT - DO NOT USE FORWARD FACING BEFORE THE CHILD'S AGE EXCEEDS 15 months (Refer to instructions)".

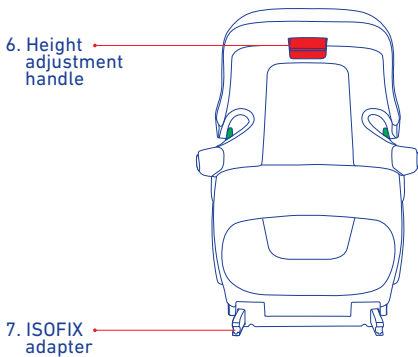
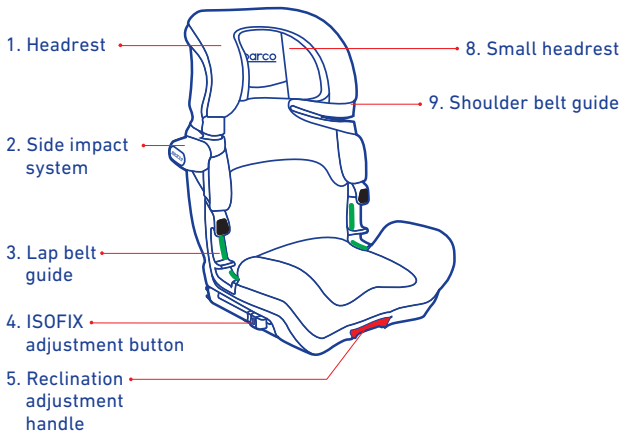

CONTENTS

Instructions before installation	05
Safety instructions	07
Installation and dismantle of ISOFIX system	09
Stature:100-150cm Installation:Vehicle 3 point beltr....	11
Stature:100-150cm Installation:Vehicle 3 point belt + ISOFIX attachment	13
Angle adjustment	15
Height adjustment	16
Install and remove side guard	17
The use of small headrest	18
Maintenance and warranty.....	19

Instructions before installation

GB

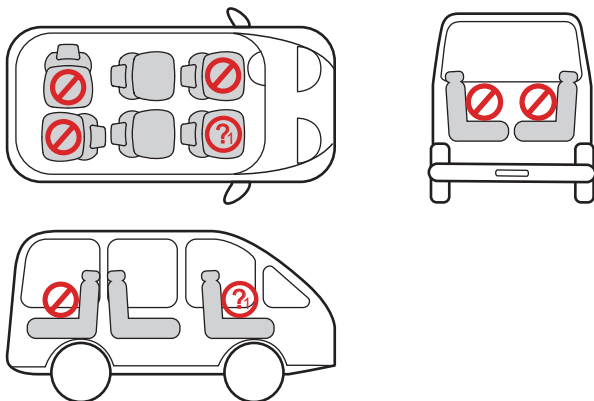

1. Child car seat should be installed on the back seat.
2. Do not install on the passenger seat in the front unless the airbag is disabled.
3. Do not install on the reverse seat.
4. Do not install on the additional seat or simple seat.
5. Make sure your ISOFIX fixture is standard.

Warning: The child seat can only be used on any vehicle seats that are equipped with Vehicle 3 point belt / ISOFIX attachment.

1. Make sure your ISOFIX mounts are standard. Please read the instructions about the ISOFIX mounts in your automotive manual
2. Never install the child restraint system unless the ISOFIX mounts match ISOFIX size class.

Instructions before installation

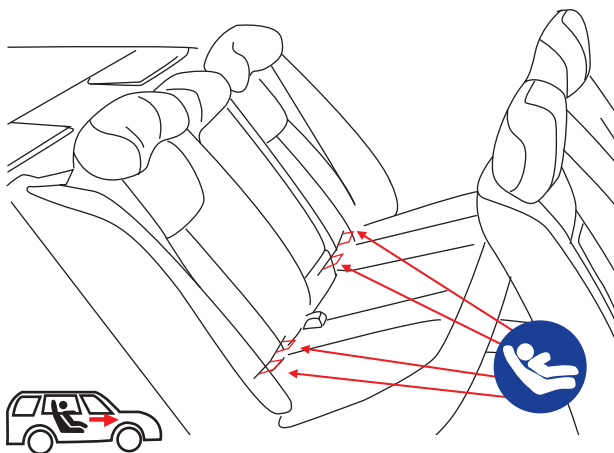

Type	Stature	Installation	Approval type	SIZE CLASS
SK800I_G23	100-135cm	Vehicle 3 point belt	I-SIZE Booster Seat	ISO/B2
		Vehicle 3 point belt + ISOFIX attachment		
	135-150cm	Vehicle 3 point belt	Specific Vehicle Booster Seat	
		Vehicle 3 point belt + ISOFIX attachment		

Safety instructions

GB

Please read all instructions thoroughly before using the SK800I_G23 Non-compliance with the instructions in this manual may affect the safety of your child!

This child restraint system shall be installed and used accordance to this manual.

1. Never use SK800I_G23 on a seat, where airbag is activated.
2. The child seat shall be away from corrosive corporation.
3. Make sure that all movable parts of your SK800I_G23 are always properly locked in place and that no parts are lodged between movable seats or doors.
4. Do not place any heavy items on the near window shelf, these can become dangerous projectiles in the event of an accident.
5. Use only manufacturer approved SK800I_G23 child seats and original accessories and do not modify the product!
6. Never use the child restraint system if any parts damaged or lost. Please contact with manufacturer or retailer.
7. Never use other stress points unmarked in this manual. And it must be marked as warning on the child restraint system.
8. Even if for short distance travel, child seat is also needed, so as to avoid occurrence of accident at any time.
9. Protect any parts of the retaining equipment not covered with fabric against direct sunlight to prevent your child from suffering burns.
10. Do not leave your child unsupervised in the restraining system, whether harnessed or not.
11. Children can often be very lively, you should therefore explain to children how important it is to always be safely fastened in. Children must understand that they should never change the way the belts are positioned and never open the buckle.
12. All passengers in the car should wear a safety belt to make a good example for your child.

Safety instructions

13. When the device is used in combination with an adult safety-belt to be used by means of the following wording: Only suitable for use in the listed vehicles fitted with 3 point, approved to ECE Regulation No.16 equivalent standards.

14. Leave some relax time during a long journey.

15. The more snugly the belt fits over your child's body, the safer your child will be. Make sure the belt fit tightly and not twisted when used in the car.

16. The lap belt shall be as low as possible to ensure the pelvic position of your child.

17. After an accident, the restraining system must be replaced or sent to the manufacturer for testing, together with an accident report.

18. The child restraint shall not be used without the cover.

19. The fabric cover is an important component and adds to the effectiveness of the seat; the seat may therefore only be used with the original cover!

20. Never use the 3-point safety belt if it has interference with the main stress point of the child restraint system.

21. Stature 135-150cm may not fit all vehicles.

Pls read the user manual carefully, and welly keep it .

Installation and dismantle of ISOFIX system

GB

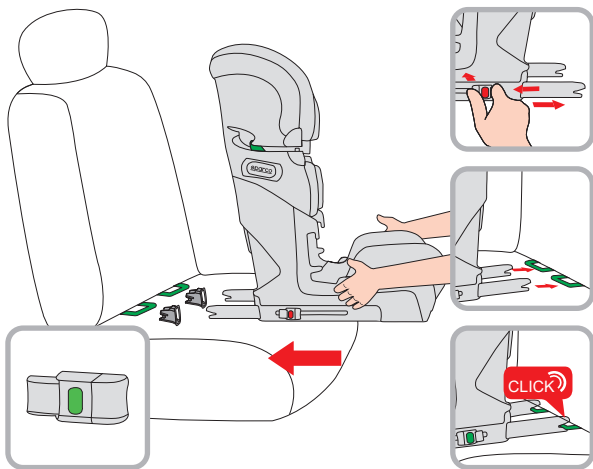

1. Insert the ISOFIX insert guide in position before installation.
2. Pinch the ISOFIX adjustment button(4) on both sides for the ISOFIX adapter(7) to extend on the rear.
3. Place the SK800I_G23 in the direction of driving on a vehicle seat or bench seat equipped with ISOFIX mounting bracket. Guide the ISOFIX adapter(7) on the ISOFIX mounting bracket of the vehicle seat and slide the child seat in the direction of the vehicle's seat backrest until both ISOFIX adapter(7) audibly latch in and the safety indicator on the side of the adapter are green.
4. Push the backrest with a substantial amount of force as far back as it will go.

Warning: The adapter are only correctly engaged if both ISOFIX indicators car completely green.

Installation and dismantle of ISOFIX system

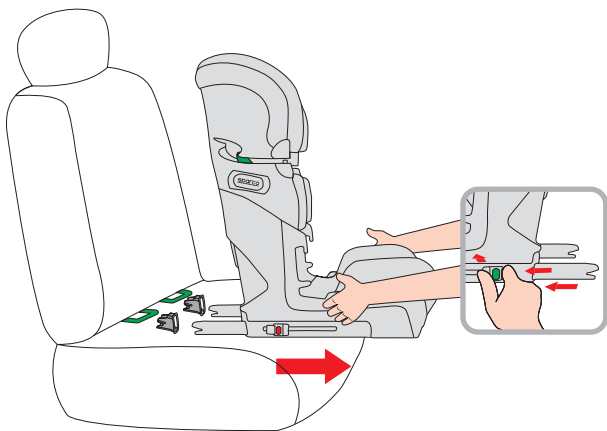

1. Pinch the ISOFIX adjustment button(4), pull out to release the ISOFIX adapter(7)

2. Pinch the ISOFIX adjustment button(4) to pull in the ISOFIX adapter(7) when you don't use it.

Stature:100-150cm

Installation:Vehicle 3 point belt



ISO/B2

Stature:100-150cm
Vehicle 3 point belt

1. Pull back the ISOFIX adapter(7) to retract state.

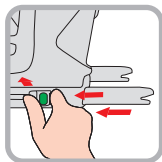

2. Put the child seat on the car seat in drive direction.



3. Adjust the SK800I_G23 to the size of your child, make sure the vehicle 3 point belt can go through the guides and can be on your child's shoulder.

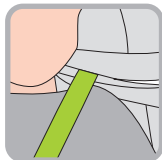

Stature:100-150cm Installation:Vehicle 3 point belt

4. Have your child sit in the safety seat with the back, shoulders, and hips tightly attached. Pull out the car seat belt and make sure that the belt of the car passes under the crotch seat belt guide (3) and the shoulder belt passes over the top of crotch guide (3) and the shoulder belt guide (9).

5. The safety belt shall not be twisted, then adjust the tightness to make sure the child seat is installed, not shaking.

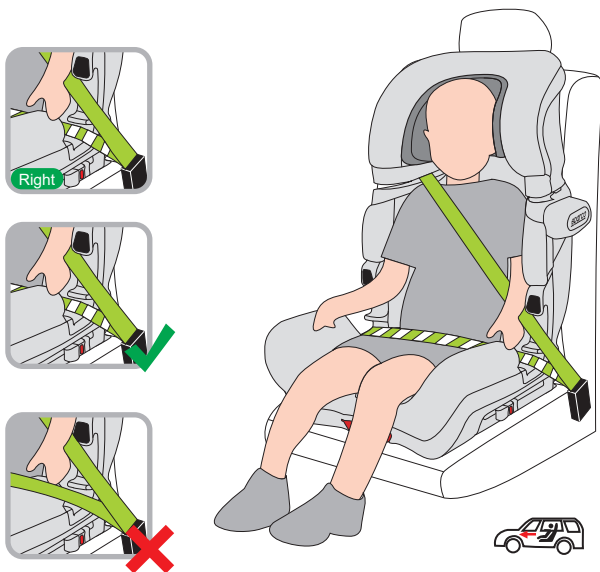

Stature: 100-150cm Installation: Vehicle 3 point belt + ISOFIX attachment



ISO/B2

Stature: 100-150cm
Vehicle 3 point belt + ISOFIX attachment

1. Place the SK800I_G23 in the direction of driving on a vehicle seat



2. Guide the ISOFIX adapter(7) on the ISOFIX mounting bracket of the vehicle seat and slide the child seat in the direction of the vehicle's seat backrest until both ISOFIX adapter(7) audibly latch in and the safety indicator on the side of the adapter are green.



3. Adjust the SK800I_G23 to the size of your child, make sure the vehicle 3 point belt can go through the guides and can be on your child's shoulder.

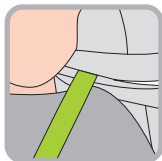

Stature:100-150cm
Installation:Vehicle 3 point belt
+ ISOFIX attachment

4. Have your child sit in the safety seat with the back, shoulders, and hips tightly attached. Pull out the car seat belt and make sure that the belt of the car passes under the crotch seat belt guide (3) and the shoulder belt passes over the top of crotch guide (3) and the shoulder belt guide (9).

5. The safety belt shall not be twisted, then adjust the tightness to make sure the child seat is installed, not shaking.



Angle adjustment

GB

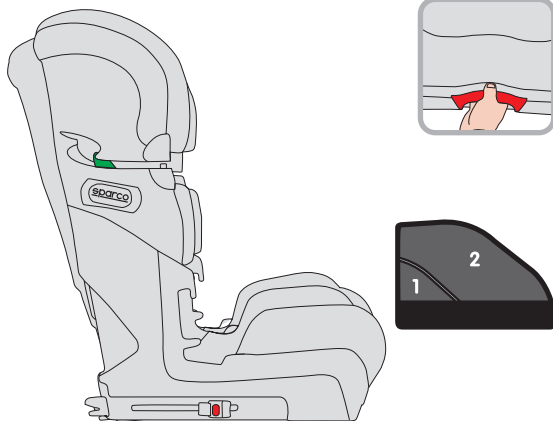

Press and pull the Reclination adjustment handle (5), and push the seat into the desired position. There are two reclinations, which can be adjusted to the right position according to the needs of your child.

Height adjustment

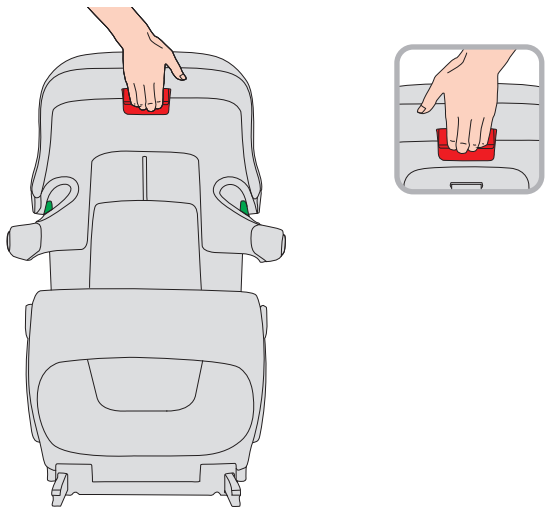

1. Hold the height adjustment handle (6) and adjust the seat height to the size of the child.

NOTE: With the adjustment of headrest, the seat will simultaneously adjust the height and meanwhile, the shoulder strap also goes as the child size.

Install and remove side guard

GB



1. Installation: find the installation card slot on the side of the seat, insert the buckle of the side bump block into the card slot, and then push it. The side bump block slides forcefully to the right and locks.
2. Disassembly: push the side bump to slide forcefully to the left. After unlocking, remove the side bump.

NOTE: the side impact block should be installed near the window of the car, so as to play better Anti side impact.

The use of small headrest



Stature: 100-150cm

When in stature 100-150cm, the small headrest must be used.

NOTE: stature 100-150cm, the small headrest should be always used.

Care instructions:

1. Please use the original seat cover and it cannot be removed for washing.
2. Original cover can not be replaced by other materials not from manufacturer, the cover material affects the performance of the child restraint system.
3. Please use the original cushion and consult dealer or manufacturer for replacement of new cushion.
4. Do not take off the buckle or buckle tongue.
5. The belt can be washed by commercially-available detergent.

Storing SK800I_G23

Store SK800I_G23 in a dry place and protect it from dust and direct sunlight.

Guarantee Date of effect

The guarantee begins on the day of purchase, and within the warranty period of 24 months(with normal use as described in the user manual)

Warranty terms:

- a. The guarantee is valid for the original purchaser only, not transferable;
- b. The guarantee makes no provision for any alteration or deterioration to the product that is incurred through normal usage.
- c. The period of guarantee shall not be extended by any remedial measures carried out by the manufacturer in the event of a claim.
- d. A free replaced child seat will be provided by the manufacturer after an accident.



www.sparcokids.pl