

76-150
cm

User Manual

We are pleased that our child car seat may accompany your child safely through a new stage of his or her life.

In order to protect your child correctly, This baby car seat must always be used and installed as described in these instructions. If you have any other questions regarding its using, please contact us.

Contents

1. Important Notice.....	3
2. Features.....	6
3. The attention for car using.....	8
4. The adjustment and using of the child car seat.....	9
4-1 Recline position of adjustment.....	9
4-2 Harness adjustment.....	9
4-3 Headrest adjustment.....	10
4-4 Buckle adjustment.....	10
4-5 5 point harness system removing.....	11
4-6 ISOFIX installation and removing.....	12
4-7 Top Tether using.....	13
4-8 Inner cushion using.....	13
4-9 Usage of the SSP.....	13
4-10 Removing and refitting the upholstery.....	14
5. Installation.....	14
5-1 76cm-105cm(≤18kg) ISOFIX+TT+harness system to fix the baby car seat.....	14
5-2 100cm-150cm Vehicle 3-point belt + optional ISOFIX attachment to fix the baby car seat.....	15
6. Cleaning and maintenance.....	16
7. Notice.....	17

1.Important Notice

1.This child car seat is suitable for child's stature 76cm-105cm/ ≤ 18 kg i-Size-universa ISOFIX 、 100cm-135cm i-Size booster seat 、 135cm-150cm Specific Vehicle booster seat.

2.Please get the operation manual from the the net bag, which is inside the back cover of the child seat, and read carefully.

3.Please read carefully before installation , serious injury will occur if installed incorrectly.Manufacturer won't take responsibility for any risks in this case.

4.Never use the child car seat without cover.Never use any cover which is not recommended by manufacturer to replace old cover.Because the cover constitutes an integral part of the child car seat performance.

5.When the child restraint is not provided with a textile cover, the chair should be kept away from sunlight, otherwise it may be too hot for child's skin.

6.The customer shall be advised not to use them in seating positions where there is an active frontal airbag installed.

7.The device should be replaced when it has been subject to violent stresses in an accident.

8.Please ensure all passengers in the car use safety belt, goods in car must be fixed, otherwise the passengers and goods may injure child when in emergency brake situation.

9.Buckle can't be in semi-locked status. Always confirm the child car seat is locked before using in case of emergency child can be taken out quickly.

10.Don't make any changes,additions or changes the way of harness system which in the child car seat, otherwise could seriously affect the security and functionality.

11.The user concerning the danger of making any alterations or additions to the device without the approval of the Type Approval Authority, and a danger of not following closely the installation instructions provided by the child restraint manufacturer.

12. The children are not left in their car seat unattended.
13. Keep the child seat away from the corrosive.
14. Always keep the child car seat secured in the vehicle even when it is unoccupied, children are not left in their child car seat unattended.
15. Don't use the second-hand child car seat.
16. The importance of ensuring that any lap strap is worn low down, and that any impact shield installed properly, so that the pelvis is firmly engaged, shall be stressed.
17. Any straps holding the child car seat to the vehicle should be tight, that any straps restraining the child should be adjusted to be suitable to the child's body. and that straps should not be twisted.
18. Don't to use any load bearing contact points other than those described in the instructions and marked in the child restraint.
19. Do not use forward-facing child car seat when child stature less than 76cm.
20. The instructions can be retained on the child restraint for its life period, and please take good care of the manual.
21. The rigid items and plastic parts of a child restraint must be so located and installed that are not liable, during everyday use of the vehicle, to become trapped by a movable seat or in a door of the vehicle.
22. The user should be advised to use carry-cots perpendicular to the longitudinal axis of the vehicle.
23. Any luggage or other objects liable to cause injuries in the event of a collision shall be properly secured.
24. If you have any question about the using and installation of the child seat. Please contact our service hotline.
25. Child car seat shall not be used without the cover.

26. For an "Child Car seat", the user shall also be referred to the vehicle manufacturer's handbook.

27. The child restraint may not fit in all approved vehicles when used in one of these positions.

"IMPORTANT - DO NOT USE BEFORE THE CHILD'S AGE EXCEEDS 15 months.

2. Features

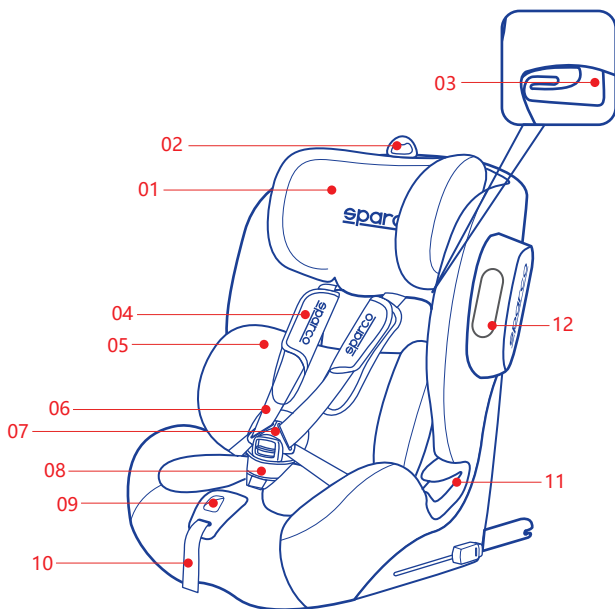

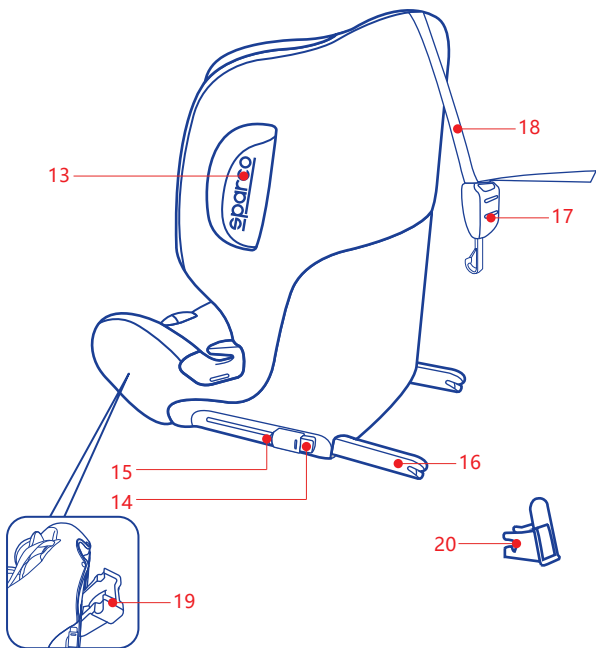

NO.	ITEM NAME	NO.	ITEM NAME	NO.	ITEM NAME	NO.	ITEM NAME
01	Headrest	02	Headrest adjustment handle	03	Shoulder belt guide	04	Shoulder pad
05	Inner cushion	06	Shoulder straps	07	Harness buckle	08	Buckle pad
09	Harness adjusting button	10	Adjustment strap	11	Belly belt guide	12	SSP fixing groove
13	SSP	14	ISOFIX 2nd lock button	15	ISOFIX release button	16	ISOFIX attachment
17	Top Tether hook	18	Top Tether	19	Recline adjustment flap base	20	ISOFIX insert guide

3. The attention for car using

! **Danger! Do not use the child car seat in the passenger seat with an active airbag. (The airbag may cause vital injure to the child)**

Please read the instruction carefully, so that the child car seat could be used correctly.



Correct device/suitable



Wrong device /not suitable

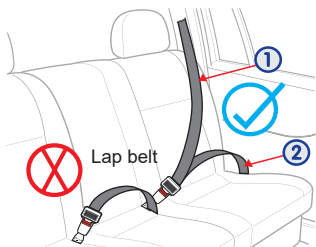

1

Car seat belt-
shoulder belt

2

Car seat belt -
lap belt

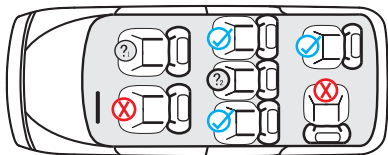

?₁

The child car seat could not be used in the front passenger seat with an airbag.

?₂

The shoulder belt, lap belt and ISOFIX are all equipped, the child car seat could be used.

4. The adjustment and using of the child car seat

GB

ES

FR

IT

PT

DE

4-1 Recline position of adjustment

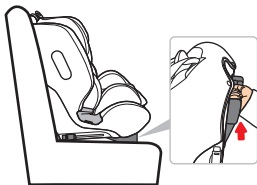

Find the recline adjustment flap base **19** and pull it up.

when reclined position used way not fit all vehicles.

4-2 Harness adjustment

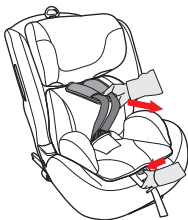

Loosen: Press the harness adjusting button **09** and grasp and pull the shoulder straps **06** (DO NOT pull shoulder pads **04**) by the other hand, and pull forward.

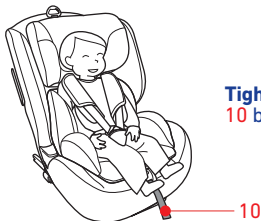

Tighten: Grasping the adjustment strap **10** by one hand, and pull forward.

4-3 Headrest adjustment

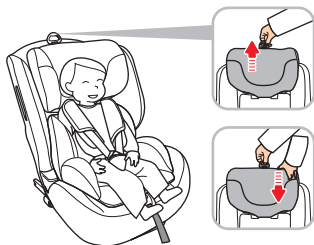

Up: Pull the headrest adjustment handle **02** up to adjust the height.

Down: Pull the headrest adjustment handle **02** up with one hand, and press the headrest **01** down with another hand.

4-4 Buckle adjustment

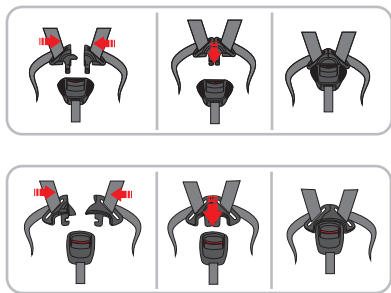

1. Put the right and left tongues of the buckle together, and insert to the harness buckle **07**, it is locked when **CLICK** is heard. Pull the quick adjuster button, tighten the shoulder straps **06**. Adjust the shoulder straps **06** to the most suitable length to make the child more comfortable (please refer 4-2 to check how to adjust the shoulder belt (there are two types of buckle of this child car seat. Please figure out which buckle is used. The function and performance are same).

Tips: Press the red button then release the buckle.

4-5 5 point harness system removing

GB

ES

FR

IT

PT

DE

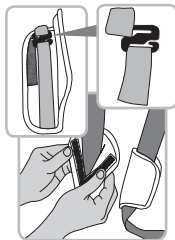

1. Tear the shoulder pads **04**, and separate the shoulder pad connector and remove the shoulder pads.
2. Pull out the inner cushion **05**, release the harness buckle **07**, pull out buckle pad **08**, store the buckle under the upholstery, store the shoulder straps **06** and buckle latches together under the upholstery.

4-6 ISOFIX installation and removing

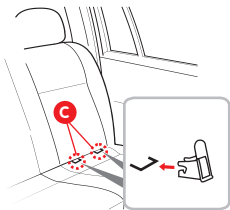

ISOFIX Installation

1. If your vehicle is not equipped with the ISOFIX insert guides as standard. Clip the two ISOFIX insert guides 20 which are included with the seat with the cut-out facing upwards onto the two ISOFIX attachment point C of your vehicle.



2. Press both the ISOFIX 2nd lock button 14 and ISOFIX release button 15, remove the ISOFIX 16.

3. Insert in ISOFIX onto two ISOFIX attachment point C, until there is a click and the indicators completely green.

4. Push the car seat with a substantial amount of force as far as it will go.

5. Shake the base of baby car seat to ensure the ISOFIX is fixed firmly.



Notice:

Children must ensure that the left and right ISOFIX gear is consistent before taking the child car seat.

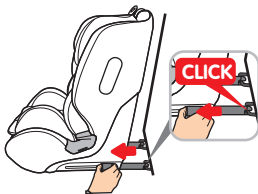

ISOFIX removing

Press both the ISOFIX 2nd lock button 14, and ISOFIX release button 15, the ISOFIX can be removed when there is a click noise.

4-7 Top Tether using

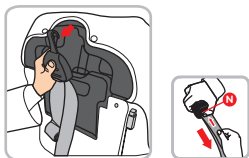

1. Take the top tether **18** out from the bottom of the car seat, adjust the Top Tether by pressing the Top Tether adjusting button **N**, pass the vehicle seat headrest.

2. Fix the top tether hook **17** on the fixing point according to the car manual, then tighten the top tether **18** (tighten the Top Tether until the indicator shows green).



Notice:

Never use luggage hook to replace the one on Top Tether, check the vehicle to find below mark.



4-8 Inner cushion using

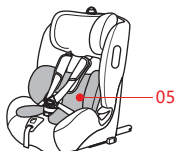

When the height of kids is below ≤ 87 cm, need to use inner cushion **05**.

Tips: The inner cushion **05** is comfortable for the kids.

4-9 Usage of the SSP(SSP optional accessory)

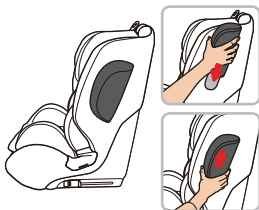

Install the SSP

Press the SSP from top to side to the SSP fixing groove.

Remove the SSP

Slip the SSP up, then it could be removed.

Notice: If you use SSP, the car seat may not fit all vehicles.

4-10 Removing and refitting the upholstery

Upholstery removing

1. Adjust the headrest to the highest position (refer to 4-3), remove inner cushion **05**.
2. Release harness buckle **07**, remove shoulder pads **04** and buckle pad **08**(refer to 4-5).
3. Remove the headrest pad and upholstery pad carefully.

Upholstery fitting

1. Adjust the backrest to most upright position and adjust the headrest to most highest position.
2. Fitting the headrest pad and upholstery pad.
3. Fitting the shoulder pads **04** and buckle pad **08**.

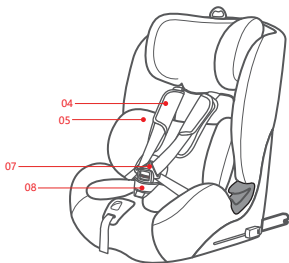

5. Installation

5-1 76cm-105cm(≤18kg)

ISOFIX+TT+ harness system to fix the baby car seat



ISO/F2X

1. Fix the ISOFIX **16** on the ISOFIX fixing point of the car(refer to 4-6).
2. Take the top tether hook **17** and pass through the vehicle seat headrest and fixing to vehicle Top Tether anchor, tighten the top tether **18**(refer to 4-7).
3. Dress the kid in car seat with 5 point harness system.

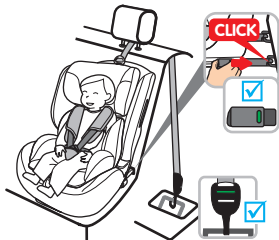



Notice:

1. Check the harness belt and vehicle belt, make sure the kid and car seat are correctly and firmly installed.
2. The Top Tether indicator will show 'green' when it is tightened.
3. Ensure no cross or twist of the harness system.
4. Use the SSP to the side near to window.
5. Open the recline adjustment flap base to adjust the recline position(refer to 4-1).

5-2 100cm-150cm
Vehicle 3-point belt + optional ISOFIX attachment to fix the baby car seat

ISO/B2

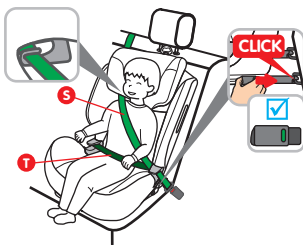
1. Removing the harness system(refer to 4-5).
2. Vehicle seat belt **S** should go through shoulder belt guide **03** and cross over the kid's shoulder.
3. Vehicle belt **T** cross the belly belt guide **11** and cross over kid's belly.
4. Shoulder belt and belly belt together go through another side belly belt guide **11** and fix the belt.
5. Fix optional the ISOFIX attachment **16** on the ISOFIX fixing point of the car(refer to 4-6).

Notice:

1. Check the vehicle belt, make sure the kid and car seat are correctly and firmly installed.
2. Ensure no cross or twist of the vehicle belt.
3. Use the SSP to the side near to window.
4. Open the recline adjustment flap base to adjust the recline position(refer to 4-1).

6. Cleaning & Maintenance

Important tips: The cover is a safety feature. Never use the child seat without it, don't put your child's safety at risk by using other replacement cover, they could stop the child seat from protecting your child because other replacement will not perform its function.

Washing instruction

The cover is removable and washable at 30 °C, line dry only.



Machine
wash, cold



Do not bleach



Do not
tumble dry



Do not iron



Dry clean,
any solvent

7. Notice

GB

ES

FR

IT

PT

DE

Notice

This is an i-Size Enhanced Child Restraint System. It is approved according to UN Regulation No. 129, for use in, i-Size compatible vehicle seating positions as indicated by vehicle manufacturers in the vehicle user's manual. If in doubt, consult either the Enhanced Child Restraint System manufacturer or the retailer.

Notice

This is an i-Size booster seat Enhanced Child Restraint System. It is approved according to UN Regulation No. 129, for use primarily in "i-Size seating positions as indicated by vehicle manufacturers in the vehicle user's manual.

If in doubt, consult either the Enhanced Child Restraint System manufacturer or the retailer.

Only suitable if the approved vehicles are fitted with 3 point safety-belts, approved to UN/ECE Regulation No. 16 or other equivalent standards.