

**sparco**  
CORSA

# CHILD CAR SEAT FOR GROUPS 2+3

## INSTRUCTION MANUAL

GB

ES

FR

IT

PT

DE

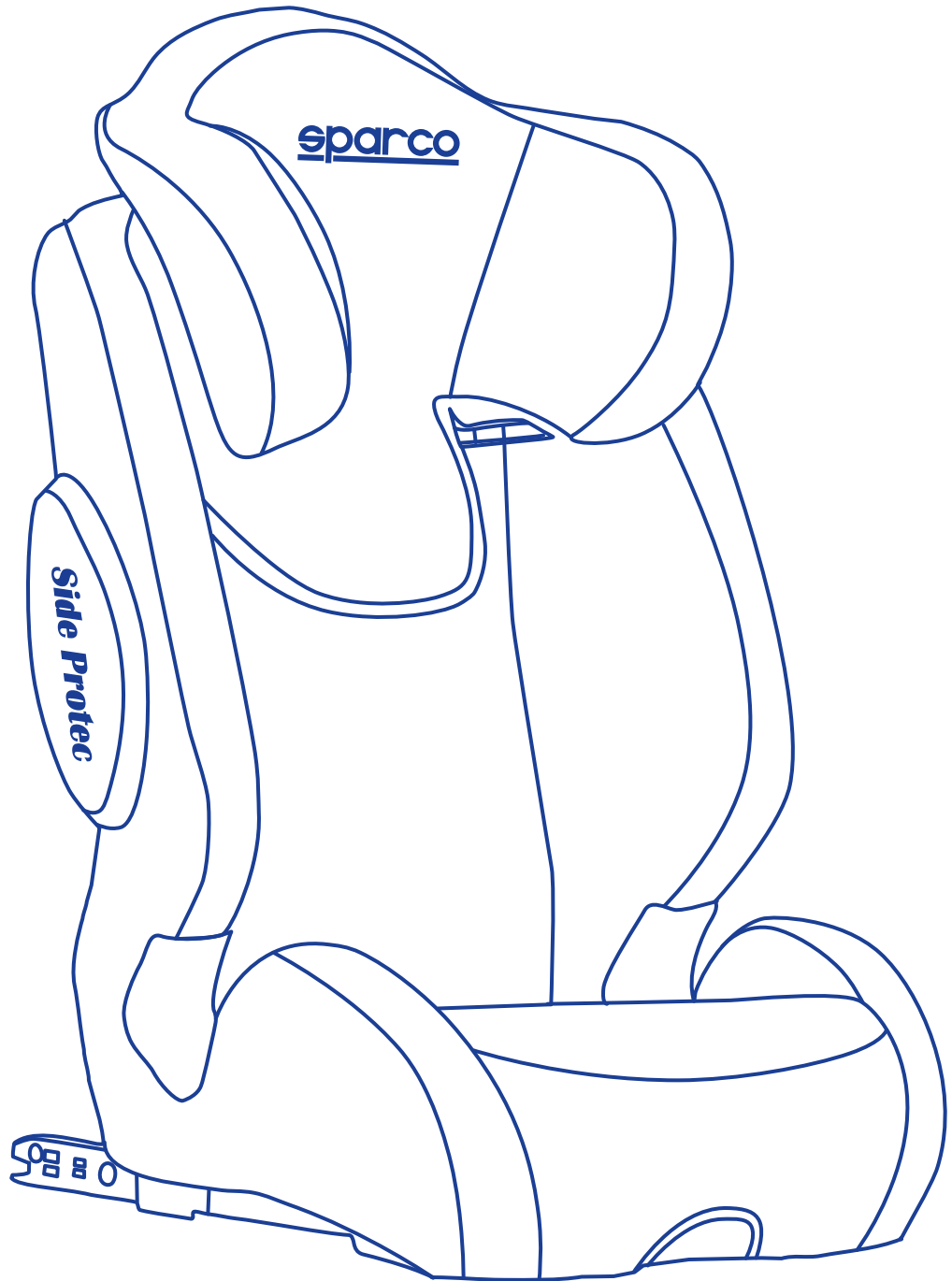

**sparco**

CORSA

**ECE R44/04**  
**GROUPS 2+3**

1. Thank you for your purchasing our child car seat.
2. Please contact our Customer Service if you have comments on the child car seat, wish to replace certain accessories, or seek help.
3. Please note that the child car seat is only suitable for fitting on a car seat compliant with ECE R16 or equivalent standards with a three-point seat belt with an emergency locking retractor.
4. It is important to always keep this Instruction Manual together with the child car seat.
5. It is a good idea to place this Instruction Manual in the bag behind the backrest of the child car seat.
6. Read this Instruction Manual thoroughly before use.

## Precautions:

### WARNING!

Do not fit the child car seat on a car seat in front of which an airbag is installed, since the airbag may harm the child upon impact. It is advisable to use the child car seat on a rear car seat only, even if your local traffic regulations allow fitting on such a front seat.

### WARNING!

Please consult your local traffic regulations, as they may vary in different countries. Check your car's owner manual for information on the possibility of fitting the child car seat on a front seat. Do not fit the child car seat on a car seat in front of which an airbag is installed, since the airbag may harm the child upon impact.

### WARNING!

Avoid letting the buckle come in contact with oil, as it may fail resulting in damage. Check before use, whether there are any crumbs or other small items which may have fallen into the buckle.

### WARNING!

Do not use any load bearing contact points other than those described in the instructions and marked in the child restraint.

## WARNING!

Never use a child car seat without a backrest, since it cannot provide maximum protection during a collision.

## WARNING!

Toxic cleaning solutions may lead to illness. Do not bleach, iron, machine-wash, or dry the child car seat covers with a roller-drier, as these methods will damage the child car seat covers and require a replacement..

## WARNING!

Appropriate adjustment of the seat belts is a key factor in protecting your child. Keep a finger-width space between your child and the seat belt.

## WARNING!

The socket of the car's seat belt should not be located above the lap belt guide of the child car seat. If this is not the case, try to fit the child car seat onto another car seat. Please contact the dealer's service department, should you have any doubts.

## General Safety Information









- Keep this Instruction Manual together with the child car seat, so you can readily access it in the future. Noncompliance with these instructions may affect your child's safety.
- After the child car seat has been placed and fitted, under normal driving conditions, there should be no compressed part under the movable seat or car door or between the two.
- Replace the child car seat which has undergone any accident, because some unforeseeable damage may have happened to the child car seat.
- Do not try to modify or add things to the child car seat without permission of the manufacturer or a competent authorizing body; otherwise, the child car seat becomes disqualified for warranty.
- Cover the child car seat to avoid direct sunlight to prevent your child from being injured by overheated parts of the child car seat.
- Do not leave your child unattended in the child car seat.

- Ensure there is no loose luggage or other similar items in the car, as they may harm passengers in the car in case of a collision.
- Always tightly secure all loose items to avoid injury to other passengers.
- Never use the child car seat without a seat cushion. Never use child car seat covers other than those recommended by the manufacturer to replace the cushion, otherwise, the protection provided by the child car seat may be compromised.
- Always ensure that the car's adult seat belt has been properly buckled while the child car seat is fitted. Use the car's adult seat belt for securing your child car seat, even if it is not in use. A loose child car seat may cause injury in the case of a collision.
- Check before use, whether there are any crumbs or other small items which may have fallen into the buckle. Such items will affect the performance of the buckle.
- Some parts of the child car seat must be replaced due to wear after several years of use. Please contact our Customer Service for replacing such parts.
- As for use in cold winter conditions, pay attention to ensure that the child's clothing does not affect the regular tension of the seat belt or affect the harness of the child car seat.

## Using your SPARCO child car seat

- Understand how to properly fit the child car seat before using it.
- Become familiar with the features and functions of the child car seat to ensure a proper fit.
- Take time to read and understand these instructions, as this is the best way to ensure the best use of your child car seat.
- Review the safety precautions from time to time.
- Prepare the child car seat for your child, such as properly setting the seat belts, before using the child car seat in your car.

# EU Standard ECE R44 04

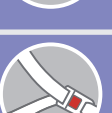
Group	Weight	Age	Orientation	Fixing of child
Group 0	0-10 kg	0-10 months	Backward facing 	Child seat belt (5 points) 
Group 0+	0-13kg	0-18 months	Backward facing 	Child seat belt (5 points) 
Group 1	9-18kg	9 months – 4 years	Forward facing 	Child seat belt (5 points) 
Group 2	15-25kg	3-7 years	Forward facing 	Car's seat belt (3 points) 
Group 3	22-36kg	6-12 years	Forward facing 	Car's seat belt (3 points) 

**NOTE:** that the seat is designed to be secured with a 3-point seat belt with an emergency locking retractor. Never use the child car seat with a 2-point seat belt.

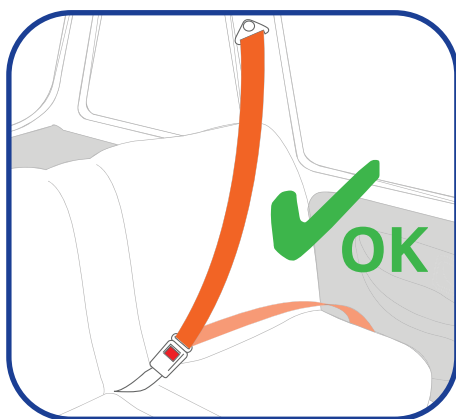

**NOTE:** that the seat is only suitable for fitting on a car seat compliant with ECE R16 or equivalent standards with a three-point seat belt with an emergency locking retractor.

# Know your child seat

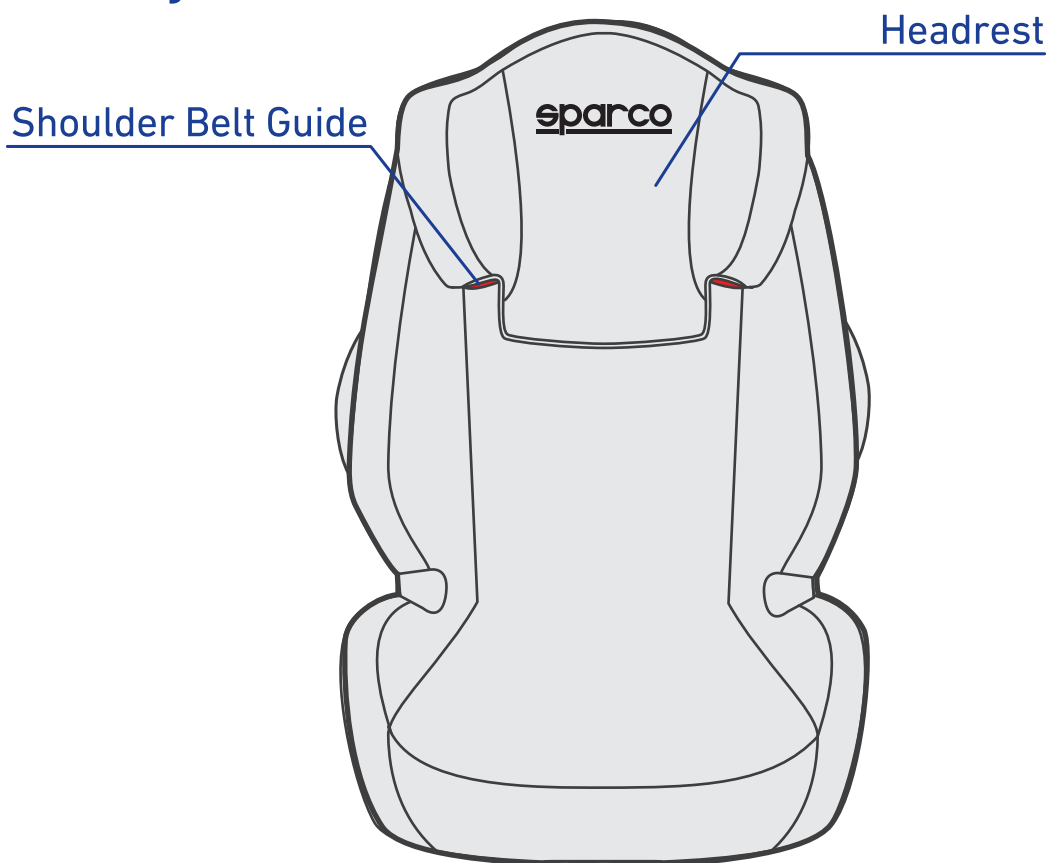



# Securing your baby

GB

ES

FR

IT

PT

DE

## 1.1 How to adjust the headrest positions

### - Eight heights of the headrest

- The headrest can be set at 8 position.

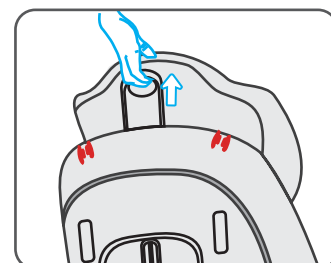

- Press and pull the handle behind headrest. It is important to make sure the headrest fit properly to head.



### - Two positions adjustment mechanism

- This car seat can be reclined to two different seating position by pulling adjusting board under seat base as shown in right pictures.

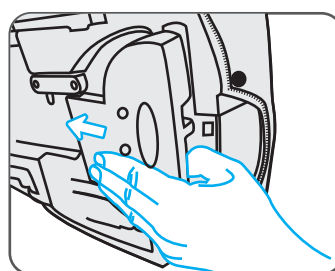
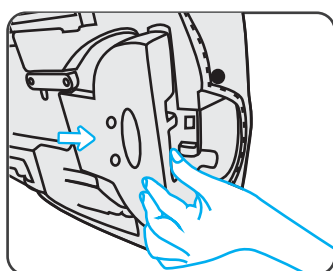

# Installation in the vehicle

## 2. Installation in the vehicle

 Please do not leave your child unattended in the child safety seat in the vehicle.

 For the protection of all vehicle occupants.

In the case of an emergency stop or an accident unsecured persons or objects may cause injury to other vehicle occupants. Please always check that...

- The backrests of the vehicle seats are locked (i.e. that a foldable rear seat bench latch is engaged).
- All heavy or sharp - edged objects in the vehicle (e.g. on the parcel shelf) are secured.
- All persons in the vehicle have their seat belts fastened.
- The child safety seat is always secured when it is in the vehicle, even if no child is being transported.

### To protect your vehicle

Some vehicle seat covers of sensitive materials (e.g. velour, leather, etc.) may develop wear marks when child seats are used. This can be avoided by placing a blanket or towel under the child seat.

# Group II/III Car Belt with ISOFIX Installation

## 2.1 Installation of Group II/III and it is for the children whose weight between 15 - 36kg. Recommended use.

**WARNING** Do not to use any load bearing contact points other than those described in the instructions and marked in the child restraint. The belt must be routed as shown in the instructions.

- Press the ISOFIX release button and push the ISOFIX connectors forward as far as.

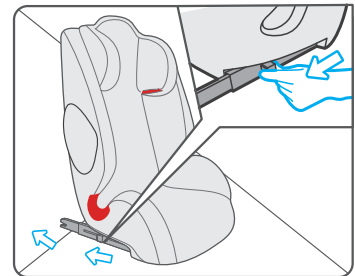

- Push the ISOFIX connectors directly into the anchorages until heard an audible sound.

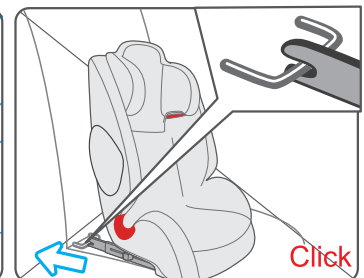
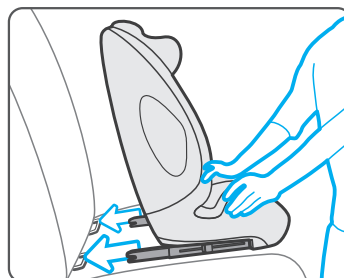

- Grasp the seat body to check the seat if it is fastened tightly or shakes. if the seat shakes and the ISOFIX connectors are pulled out, please repeat the above steps and install it .

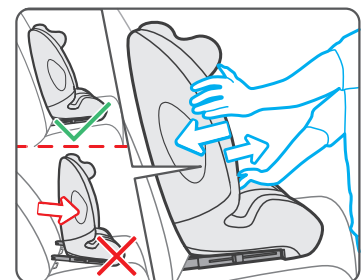

**Then follow the section 2.2 to finish the installation.**

# Group II/III Car Belt Installation

## 2.2 Installation of Group II/III and it is for the children whose weight between 15 - 36kg.

**WARNING** Do not to use any load bearing contact points other than those described in the instructions and marked in the child restraint. The belt must be routed as shown in the instructions.

- Adjust the height of the headrest to suit your child.

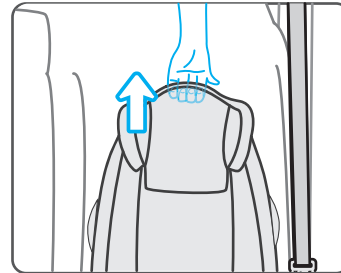

- Put the shoulder belt through the shoulder belt guide under the headrest.

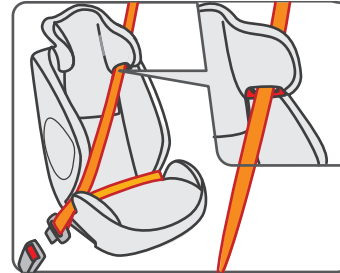

- Place your child on the car seat and pass the belts through the red waist belt guide. Fasten the car belt with an audible sound "click".

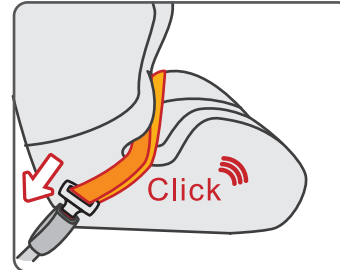

- Make sure the Lap belt is stretched as low as possible over the child's hips, within the belt guides, and fastened into the buckle. The shoulder belt must cross midway between child's shoulder and neck.

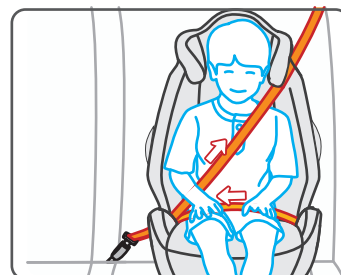

### 3. Cleaning

Please be sure to use only original seat covers, as the seat cover is important to the proper functioning of the system. Replacement seat covers are available from your retailer and or at branches.



The child seat must not be used without the seat cover.

- The cover can be removed and washed with a mild detergent using the washing machine's cycle for delicate items (30°C). Please observe the instructions on the washing label of the cover.
- The colors of the cover may fade if washed at more than 30°C. Do not spins, and never tumble-dries in an electric clothes dryer (the fabric may separate from the padding).
- The plastic parts can be cleaned using soapy water. Do not use harsh cleaning agents (such as solvents).
- The harness can be removed and washed in lukewarm soapy water.

Caution! Never remove the buckle tongues from the straps.

## CAUTIONS

1. This is a "Universal" child restraint. It is approved to Regulation No. 44, 04 series of amendments, for general use in vehicles and it will fit most, but not all, car seats.
2. A correct fit is likely if the vehicle manufacturer has declared in the vehicle handbook that the vehicle is capable of accepting a "Universal" child restraint for this age group.
3. This child restraint has been classified as "Universal" under more stringent conditions than those, which applied to earlier designs, which do not carry this notice.
4. Only suitable if the approved vehicles are fitted with 3 point static/with retractor safety-belts, approved to UN/ECE Regulation No. 16 or other equivalent standards.
5. If in doubt, consult either the child restraint manufacturer or the retailer.

**sparco**

**CORSA**

LICENSED BY **sparco**<sup>®</sup>

Produced and distributed under Sparco's licence by :  
CAR PARTS DESIGN TRADING CO., LTD. · 21st Floor Tai Yau Building 181  
Johnston Road Wanchai, Hong Kong · [info@carpadesign.net](mailto:info@carpadesign.net) [www.carpadesign.net](http://www.carpadesign.net)